



INSTRUCTION BULLETIN

No. 9016977
Machine: T16
Published: 02-2019
Rev. 00

NOTE: DO NOT DISCARD the Parts List from the Instruction Bulletin. Place the Parts List in the appropriate place in the machine manual for future reference. Retaining the Parts List will make it easier to reorder individual parts and will save the cost of ordering an entire kit.

NOTE: Numbers in parenthesis () are reference numbers for parts listed in Bill of Materials.

Installation instructions for **kit number 9016975**

SYNOPSIS:

This kit contains the parts needed to replace side brush cable keeper angle on T16 scrubbers. Please follow step-by-step instructions.

SPECIAL TOOLS / CONSIDERATIONS: NONE

(Estimated time to complete: 45 minutes)

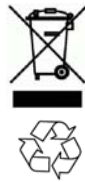

PROTECT THE ENVIRONMENT

Please dispose of packaging materials, used machine components such as batteries and fluids in an environmentally safe way according to local waste disposal regulations.

Always remember to recycle.

PREPARATION:

FOR SAFETY: Before leaving or servicing machine, stop on level surface, turn off machine, and remove key.

INSTALLATION:

1. Use two M5 hex screws (2), two flat washers (3), and two M5 hex nuts (4) to install each cable keeper spacer (5) onto the cable keeper angle (1). Torque hardware to 4.5- 5.5 Nm (3.32- 4.10 ft. lbs). (Fig. 1)
2. Disconnect the side brush cable from the side brush mounting bracket to remove tension from the cable keeper angle assembly. (Fig. 2)
3. Remove the existing cable keeper angle from the machine. Set all hardware, spacers, and the sheave aside. Discard the cable keeper angle. (Fig. 2)
4. Apply a light coat of Loctite® 243™ Blue Threadlocker onto the threads of the saved M8 screw.

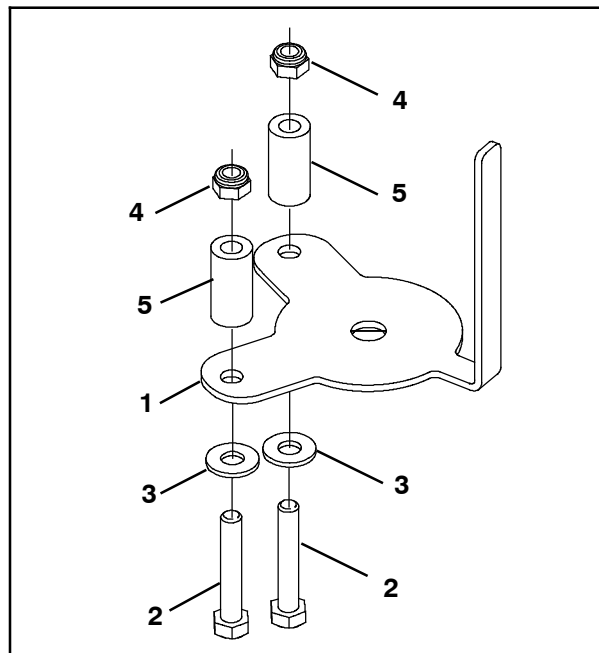

FIG. 1

Loctite® 243™ are registered trademarks of the Henkel Corporation

5. Use the M8 screw from the previous step and remaining saved hardware to install the sheave, spacers, and the new cable keeper angle (1) onto the side brush mounting bracket. Torque hardware to 16- 21 Nm (11.80- 15.50 ft. lbs). (Fig. 2)
6. Reconnect the side brush cable to the side brush mounting bracket. (Fig. 2)
7. Start and test the machine. Raise and lower the side brush and observe the newly installed cable keeper angle assembly. The cable keeper spacers (5) on the cable keeper angle (1) should not touch the sheave. The side brush should move smoothly with no binding when raised and lowered.

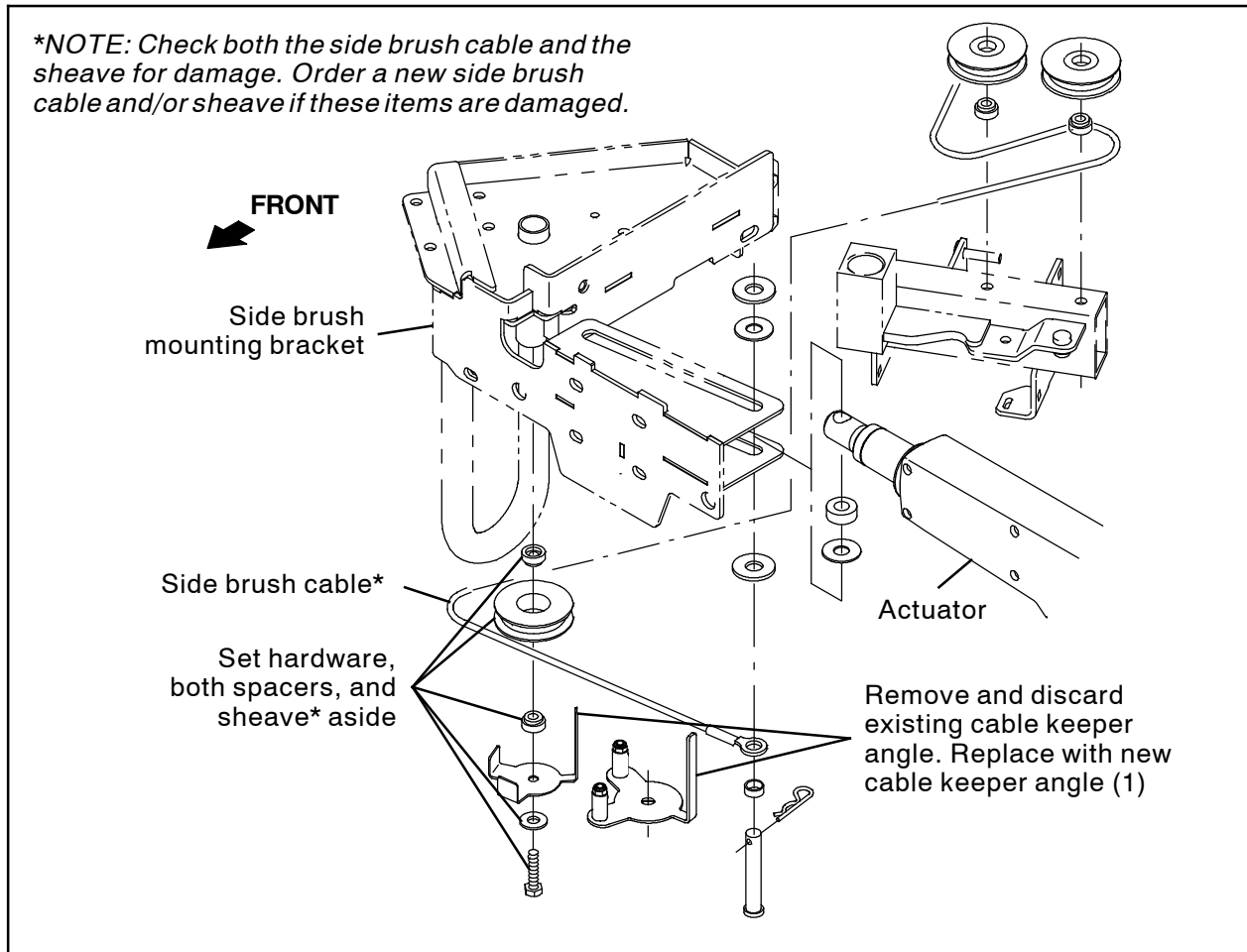

FIG. 2

Bill Of Materials For Cable Keeper Kit, Side Brush - 9016975

Ref.	Tennant Part No.	Description	Qty.
1	1234781	Angle, Keeper, Cable	1
2	1228033	Screw, Hex, M5 X 0.80 X 30, SS	2
3	01683	Washer, Flat, 10, SS	2
4	09739	Nut, Hex, Lock, M5 X 0.80, NL, SS	2
5	1234827	Spacer, Cable Keeper	2

TENNANT COMPANY
P. O. Box 1452
Minneapolis, MN 55440-1452